

THIS DRAWING IS UNPUBLISHED. RELEASED FOR PUBLICATION 20
 © COPYRIGHT 20 BY TYCO ELECTRONICS CORPORATION. ALL RIGHTS RESERVED.

LOC	DIST	REVISIONS			
P	LTR	DESCRIPTION	DATE	DWN	APVD
	L1	REVISED ECO-07-008909	24APR2007	SW	CR
	L2	REVISED PER ECO-07-015282	28JUN2007	SS	CR

TEST FACILITY

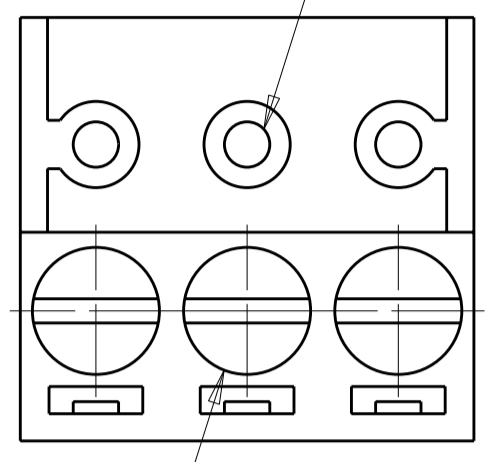

CLAMPING SCREW

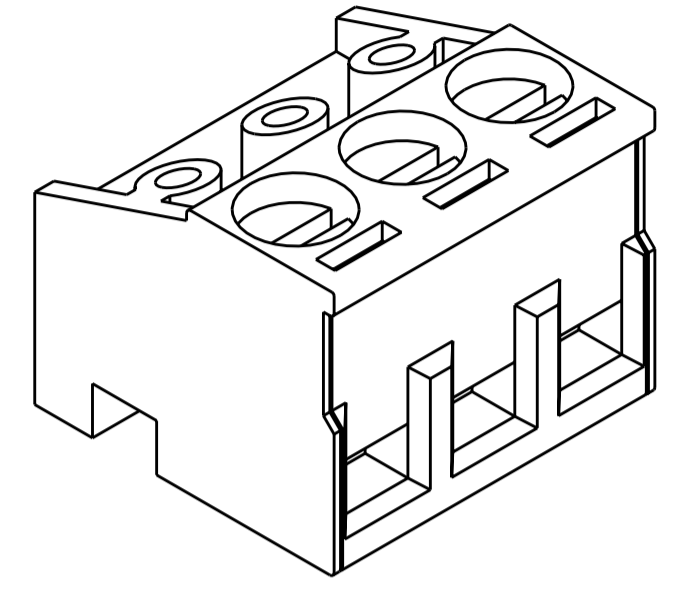

282830-3 AS SHOWN

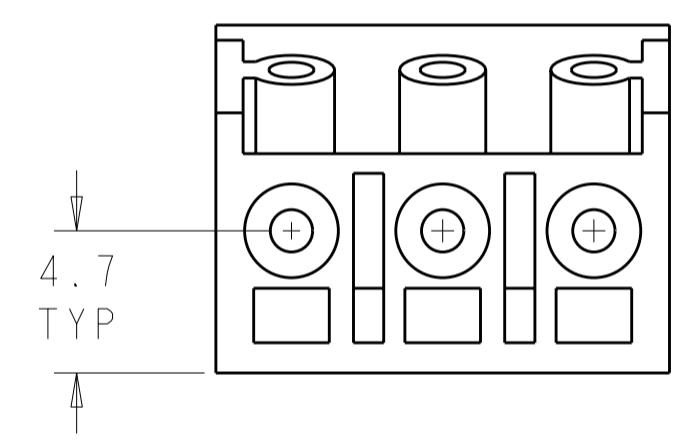
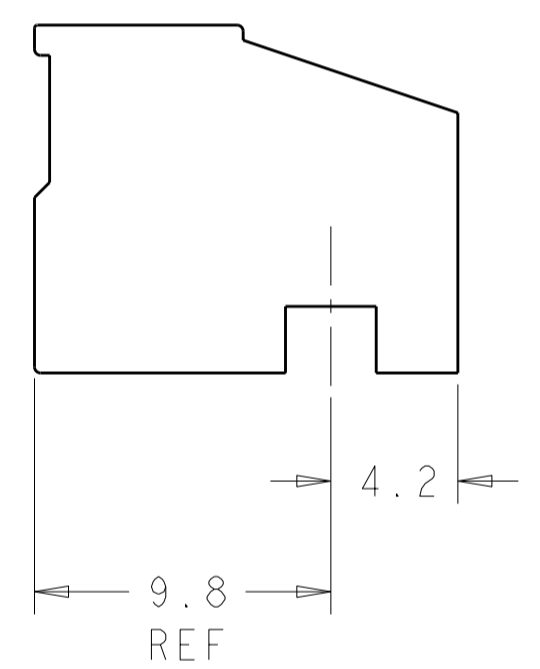
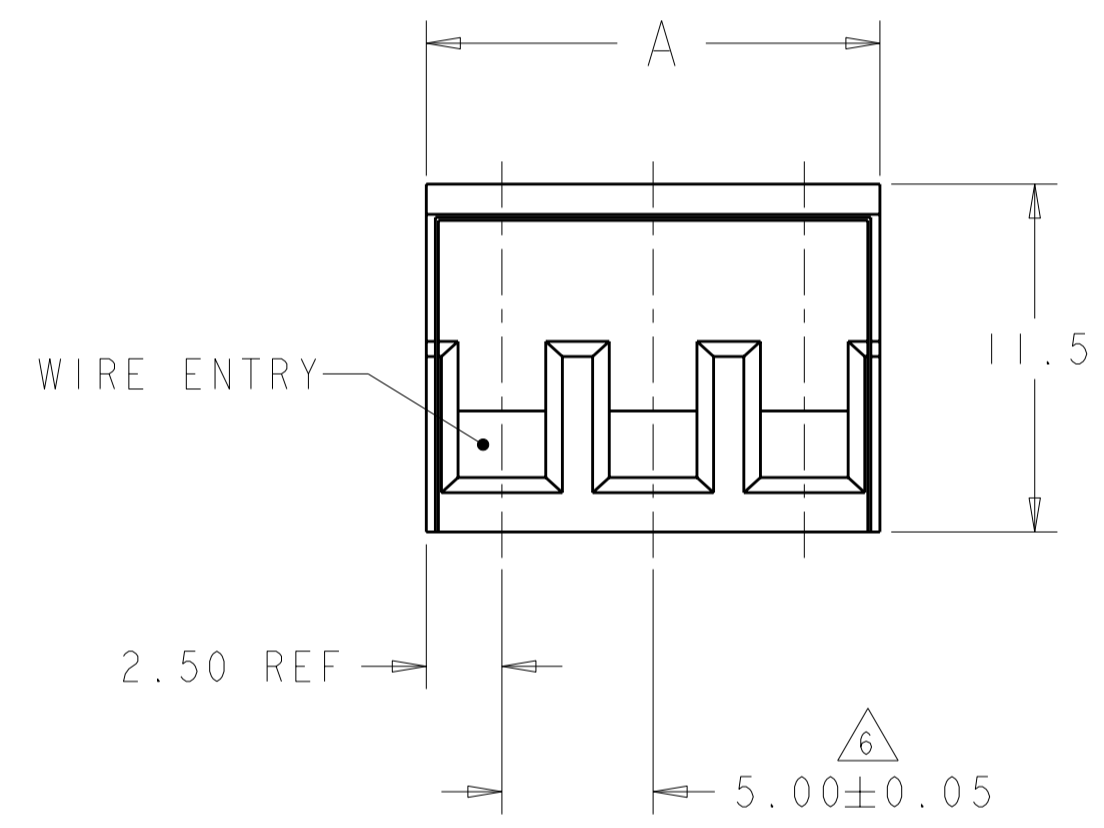

1 MATERIALS AND FINISH
 HOUSING: PA 6-6, UL 94-V0, COLOR GREEN.
 CLAMP: BRASS, NICKEL PLATED.
 CONTACT: PHOSPHOR BRONZE, PLATING: SEE TABLE
 CLAMPING SCREW: M3, BRASS, NICKEL PLATED.

- 2. END-TO-END STACKABLE WITHOUT LOSS OF CENTERLINE SPACING.
- 3. WIRE SIZE RANGE: 12-30 AWG
- 4. RECOGNIZED UNDER THE COMPONENT PROGRAM OF UNDERWRITERS LABORATORIES INC. FILE N° E60677.
- 5. IMQ CERTIFICATE WITH SURVEILLANCE IN CONFORMITY WITH IEC 998-1/998-2-1.

- 6 NOT CUMULATIVE TOLERANCE.
- 7 INK MARKING, BLACK COLOR.
- 8 INK MARKING, WHITE COLOR.
- 9 WIRE ENTRY IN THE CLOSED POSITION.

PRELIMINARY		0.254um GOLD		10	2	3-282830-6
-	-	TIN	-	30	6	3-282830-5 ⁹
-	-	TIN	-	15	3	3-282830-4 ⁹
SEE DETAIL S	TIN	-	10	2	3-282830-3	
SEE DETAIL T	TIN	-	45	9	3-282830-2	
SEE DETAIL V	TIN	-	30	6	3-282830-1	
SEE DETAIL W	TIN	-	15	3	3-282830-0	
-	GOLD	-	15	3	2-282830-9	
-	TIN	SEE DETAIL Z	55	10	2-282830-8	
-	TIN	SEE DETAIL Y	55	10	2-282830-7	
-	TIN	-	125	25	2-282830-6	
-	TIN	-	120	24	2-282830-5	
-	TIN	-	115	23	2-282830-4	
-	TIN	-	110	22	2-282830-3	
-	TIN	-	105	21	2-282830-2	
-	TIN	-	100	20	2-282830-1	
-	TIN	-	95	19	2-282830-0	
-	TIN	-	90	18	1-282830-9	
-	TIN	-	85	17	1-282830-8	
-	TIN	-	80	16	1-282830-7	
-	TIN	-	75	15	1-282830-6	
-	TIN	-	70	14	1-282830-5	
-	TIN	-	65	13	1-282830-4	
SEE DETAIL X	TIN	-	20	4	1-282830-3	
-	TIN	-	60	12	1-282830-2	
-	TIN	-	55	11	1-282830-1	
-	TIN	-	50	10	1-282830-0	
-	TIN	-	45	9	282830-9	
-	TIN	-	40	8	282830-8	
-	TIN	-	35	7	282830-7	
-	TIN	-	30	6	282830-6	
-	TIN	-	25	5	282830-5	
-	TIN	-	20	4	282830-4	
-	TIN	-	15	3	282830-3	
-	TIN	-	10	2	282830-2	

INK STAMPING	CONTACT PLATING	SELECT LOADED	A	NO OF POSN	PART NUMBER
<small>THIS DRAWING IS A CONTROLLED DOCUMENT FOR TYCO ELECTRONICS CORPORATION. IT IS SUBJECT TO CHANGE AND THE CONTROLLING ENGINEERING ORGANIZATION SHOULD BE CONTACTED FOR THE LATEST REVISION.</small>					
DIMENSIONS: mm 		TOLERANCES UNLESS OTHERWISE SPECIFIED: 0 PLC ± 1 PLC ±0.3 2 PLC ±0.25 3 PLC ±0.000 4 PLC ±0.000 ANGLES ± FINISH		DWN S. WELDON 16SEP2003 CHK C. RICHARD 16SEP2003 APVD C. RICHARD 16SEP2003 PRODUCT SPEC APPLICATION SPEC WEIGHT CUSTOMER DRAWING	
Tyco Electronics Harrisburg, PA 17105-3608			NAME TERMINAL BLOCK PLUG, 90/180 DEGREE, STACKING, 5.00mm PITCH		
MATERIAL		SIZE A2 CAGE CODE 00779 DRAWING NO C-282830		RESTRICTED TO SHEET 1 OF 2 REV L2	

THIS DRAWING IS UNPUBLISHED. RELEASED FOR PUBLICATION 20
 © COPYRIGHT 20 BY TYCO ELECTRONICS CORPORATION. ALL RIGHTS RESERVED.

LOC	DIST	REVISIONS			
P	LTR	DESCRIPTION	DATE	DWN	APVD
FT	0	-	SEE SHEET 1	-	-

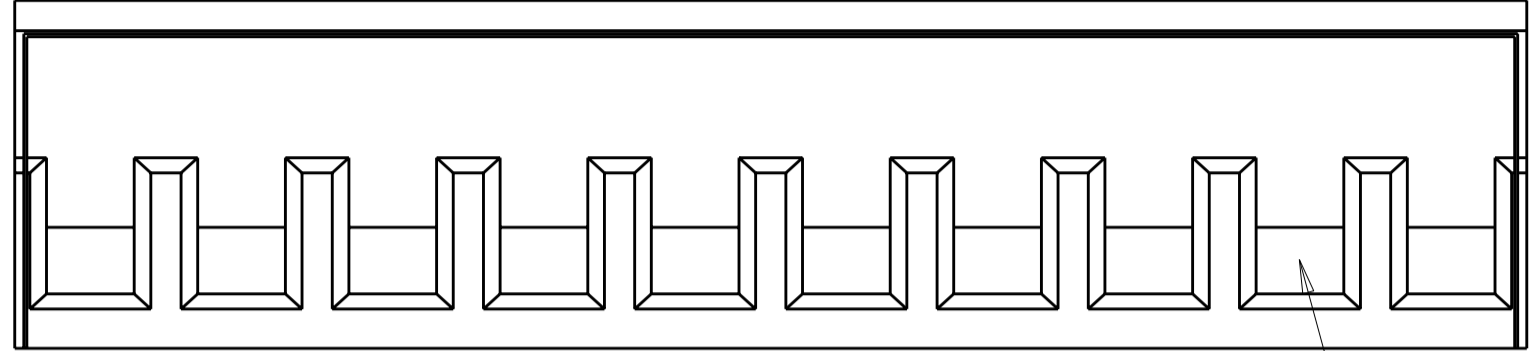

DETAIL Y

POSITION 10 IS EMPTY

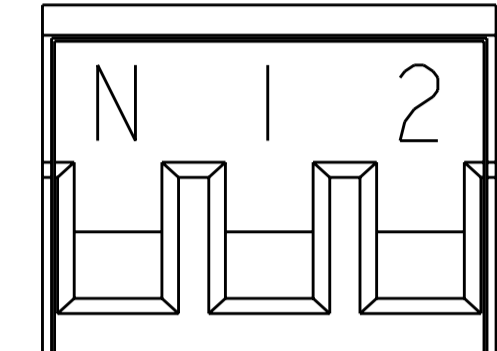

DETAIL W

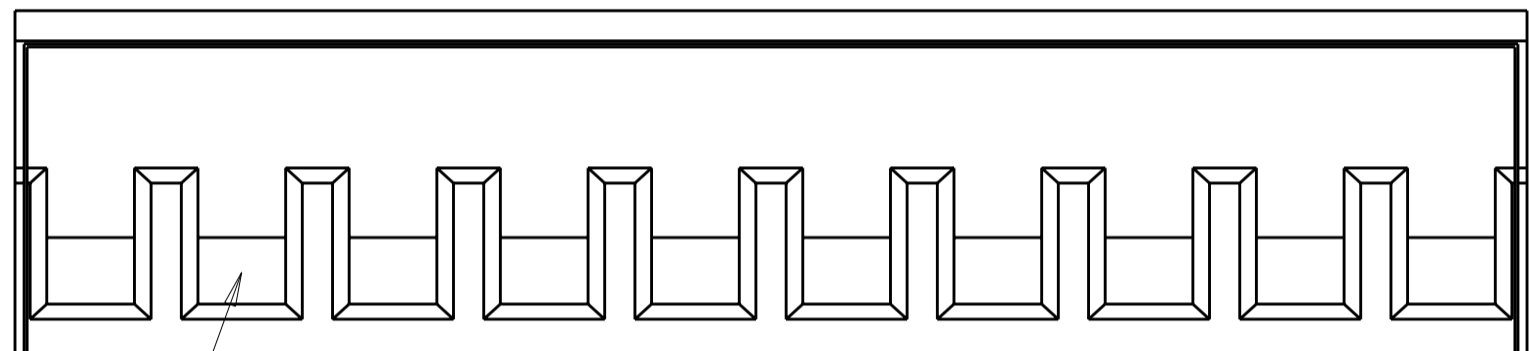

DETAIL Z

POSITION 2 IS EMPTY

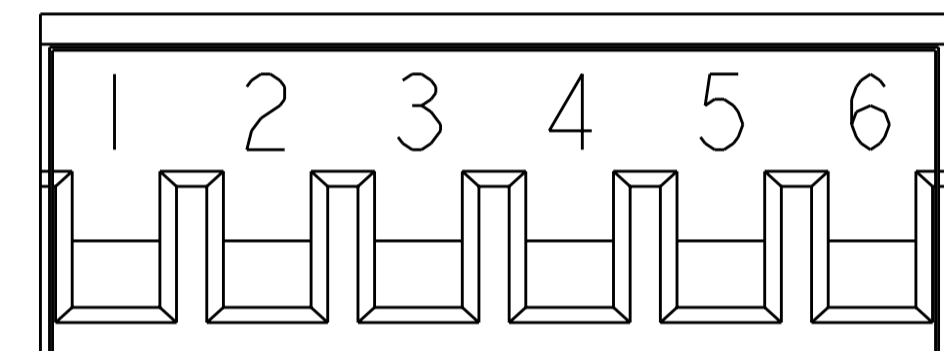

DETAIL V

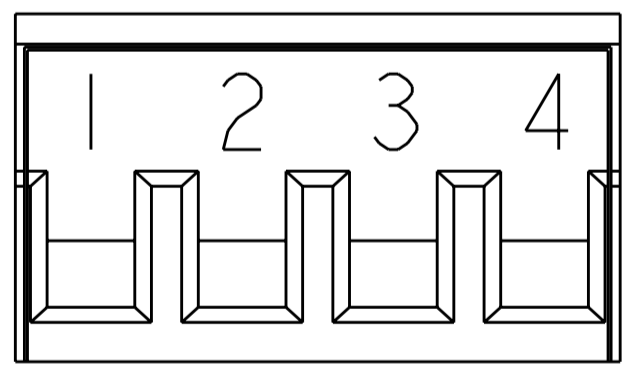

DETAIL X

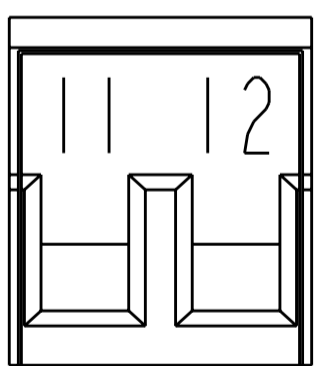

DETAIL S

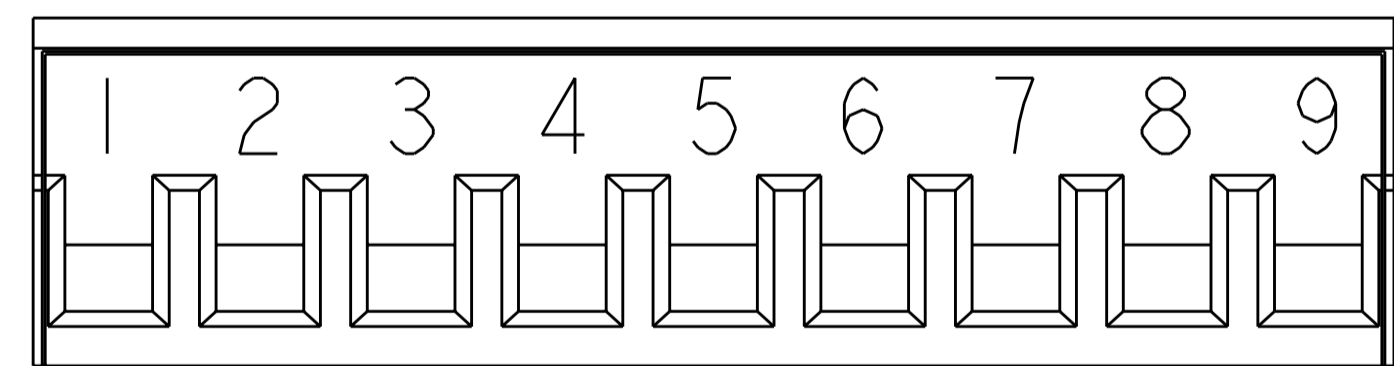

DETAIL T

<small>THIS DRAWING IS A CONTROLLED DOCUMENT FOR TYCO ELECTRONICS CORPORATION IT IS SUBJECT TO CHANGE AND THE CONTROLLING ENGINEERING ORGANIZATION SHOULD BE CONTACTED FOR THE LATEST REVISION.</small>		DWN S. WELDON 16SEP2003 CHK C. RICHARD 16SEP2003 APVD C. RICHARD 16SEP2003	Tyco Electronics Harrisburg, PA 17105-3608
DIMENSIONS: mm	TOLERANCES UNLESS OTHERWISE SPECIFIED: 0 PLC ± 1 PLC ±0.3 2 PLC ±0.25 3 PLC ±0.000 4 PLC ±0.000 ANGLES ± FINISH	PRODUCT SPEC APPLICATION SPEC WEIGHT	NAME TERMINAL BLOCK PLUG, 90/180 DEGREE, STACKING, 5.00mm PITCH
MATERIAL		CUSTOMER DRAWING	SIZE A2 CAGE CODE 00779 DRAWING NO. C-282830 RESTRICTED TO
		SCALE 4:1	SHEET 2 OF 2 REV. 12